

CONTROL CONSOLE

The EOS crane console is specifically designed for AC 50Hz (60Hz) control circuits, supporting a rated voltage up to 380V (440V). It efficiently manages the start, speed regulation, commutation, and braking of motors used in crane machinery and other similar electric control systems.

Control Box

The control box, crafted from steel plate, features a hinged cover with a standard locking mechanism for easy access and maintenance. The arrangement of the joystick, indicators, and controls is custom-configured to meet the client's specifications.



Dimensions

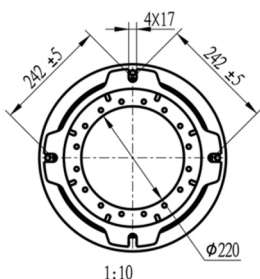

rotating base mounting

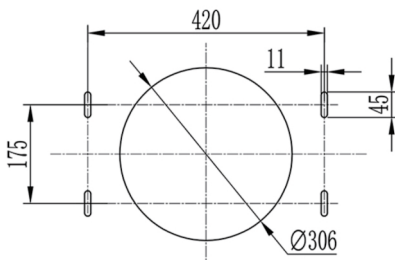

fixed base mounting

