

CONTROL CONSOLE

The TIA crane console is specifically designed for AC 50Hz (60Hz) control circuits with a maximum voltage capacity of 380V (440V). This console expertly manages the start, speed regulation, commutation, and braking of motors in crane machinery and associated electric control systems.

Control Box

The control box is crafted from robust steel plate and includes a hinged cover with a standard locking mechanism, enhancing ease of maintenance and routine checks. It's custom-configured to accommodate the joystick, indicators, and controls, precisely aligned with the client's specifications.

Dimensions

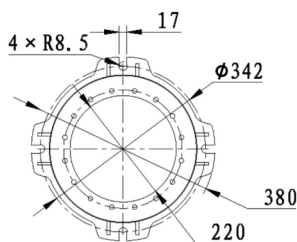

rotating base mounting

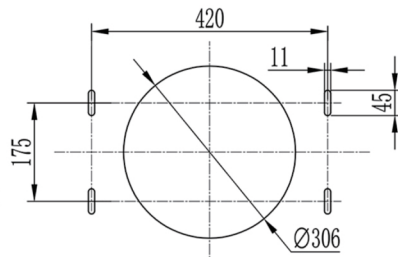

fixed base mounting

